

KTG520-R

G5Twin Compressor

Rebuild Kit

Cylinder Head Seal & Valve Kit

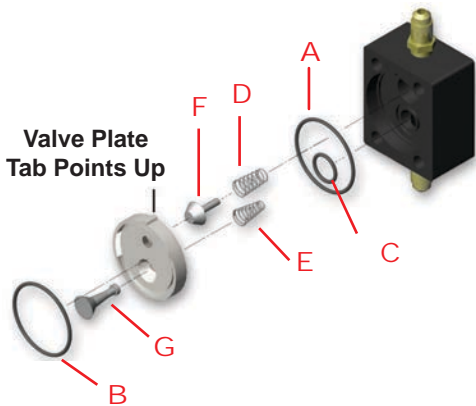

Important Note: Output Port (look for tab on valve plate) should be positioned towards the top of the compressor.

Parts Sizing Guide

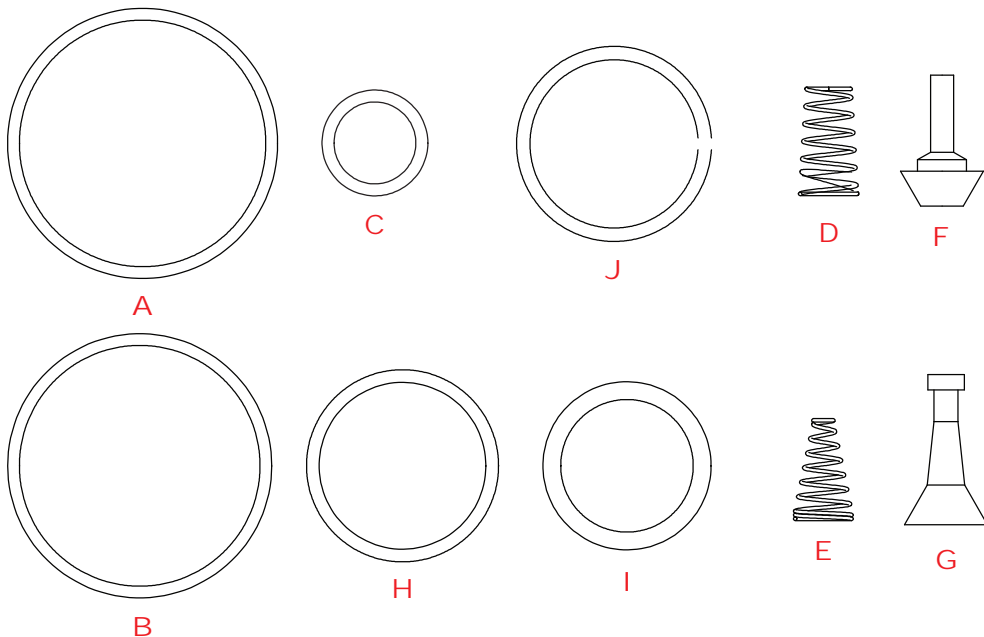

Piston Seal Kit

Important Note: Be careful not to damage the edges of the Piston while removing or installing the seals and o-rings.

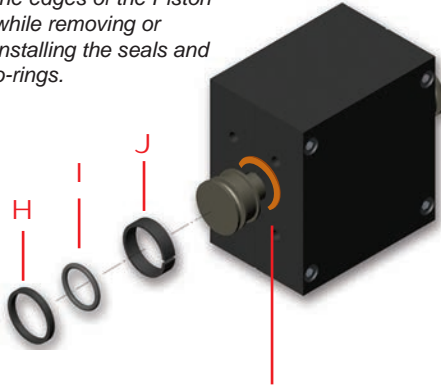

Important Note: Copper shims may be present at the base of the cylinder. A partial shim is normal, don't panic. Shims must be reinstalled in original orientation for optimal performance.

Step 1: Remove old seal and o-ring by carefully cutting them with a razor knife. (Complete each side individually for ease of assembly & to avoid part crossing.)
Caution: Do not cut or nick the piston as this may create a leak path.
(See Figure 1).

Figure 1

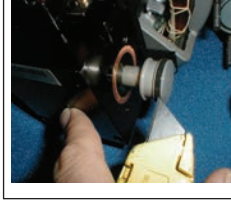

Carefully cut old seal and o-ring. Do not cut or scratch piston.

Step 2: Put a drop or two of oil (refrigerant oil preferred) on both the new seal and new o-ring before installing to aid in reseating.

Step 3: Place new o-ring in groove. Place seal partially in groove and, using a plastic rod or screw driver handle, slide rod or handle across top of piston while pressing down firmly. Gently massage seal back to shape into the groove.
(See Figure 2).

Figure 2

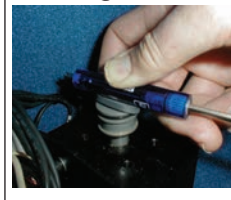

Firmly slide seal into place over new o-ring.

Step 4: Gently slide cylinder over new seals (oil helps here too). Be sure to keep spacer shim in place (if cylinder has one).
(See Figure 3).

Figure 3



Important Note: Chamfered side cylinder goes on first.

Important Note: Small Tab on valve plate goes up.

Step 5: Tighten all four bolts equally and evenly in a repeated cross pattern to keep head level.

Important Note: When replacing seals the energizing o-ring (underneath the seal) must be replaced at the same time as they can wear out.



Important Note: If the valve plates or pistons show signs of damage they will require replacement. Please contact a wholesaler.

Valve Plate Part # CA1607
Piston Part # CA1608

For a video tutorial and more helpful videos visit:

www.YouTube.com/AppionTools